



[www.lijiuomotor.com](http://www.lijiuomotor.com)

+0086-631-6681025 6681242 6609006

## Y2 系列三相异步电动机

Y2 Series Three-Phase Induction Motor



机座中心高: H63~H355mm  
额定输出功率: 0.12kW~315kW  
电源电压: 380V, 50HZ  
(可根据用户定制)  
防护等级: IP54、IP55  
绝缘等级: F  
冷却方式: IC411

Center height of frame: H63~H355mm  
Rated power: 0.12kW~315kW  
Rated voltage: 380V, 50HZ  
(can be made by the customer's requirements)  
Grade of protections: IP54、IP55  
Class of insulation: F  
Cooling type: IC411

### 概述 Outlines

Y2 系列电动机是通用的恒定转速的鼠笼型转子三相异步电动机，是 Y 系列电动机的升级产品。

该系列产品具有结构简单、坚固耐用、价格低的特点。

该系列产品适用于无特殊要求，无需变速的所有场所，广泛应用于机床、水泵、风机、压缩机、运输机、搅拌机、印刷机、农机、包装机等设备。

Y2 Series Motor is general purpose constant speed squirrel cage three phase asynchronous motor. It's an updated product of Y Series Motor.

This series product has features of simple structure, sturdy and durable, low price, etc.

This series product is widely applied to equipments without special requirements and speed regulation. It's widely used in machine tools, pumps, fan blowers, compressors, conveyors, mixers, printing machinery, agricultural machinery and packing machinery.



www.lijiu.com

+0086-631-6681025 6681242 6609006

型号 Type	额定功率 Rated Power (kW)	额定转速 Rated Speed (r/min)	效率 EFF $\eta$ (%)	功率因数 Power Factor (cos $\phi$ )	额定电流 Rated Current (A)	堵转转矩 Locked Torque	最小转矩 Min Torque	最大转矩 Max Torque	堵转电流 Locked Current	重量 Weight (kg)
						额定转矩 Rated Torque	额定转矩 Rated Torque	额定转矩 Rated Torque	额定电流 Rated Current	
Y2-132S-4	5.5	1440	85.7	0.83	11.7	2.3	1.4	2.3	7.0	58
Y2-132M-4	7.5	1440	87.0	0.84	15.6					70
Y2-160M-4	11	1460	88.4	0.84	18.2					107
Y2-160L-4	15	1460	89.4	0.85	30.1	2.2	1.2	2.3	7.5	132
Y2-180M-4	18.5	1470	90.0	0.86	36.5					172
Y2-180L-4	22	1470	90.5	0.86	43.1					188
Y2-200L-4	30	1470	91.4	0.86	57.6	2.2	1.1	7.2	7.2	243
Y2-225S-4	37	1480	92.0	0.87	69.9					297
Y2-225M-4	45	1480	92.5	0.87	84.7					333
Y2-250M-4	55	1480	93.0	0.87	103	2.1	1.0	2.2	6.9	394
Y2-280S-4	75	1480	93.6	0.87	139					531
Y2-280M-4	90	1490	93.9	0.87	167					590
Y2-315S-4	110	1480	94.5	0.88	201	2.1	0.9	2.2	6.9	844
Y2-315M-4	132	1480	94.8	0.88	240.4					934
Y2-315L1-4	160	1480	94.9	0.89	287.8					1002
Y2-315L-4	185	1480	94.9	0.89	330.8	2.1	0.8	2.2	6.9	1180
Y2-315L2-4	200	1480	94.9	0.89	358.6					1100
Y2-355M1-4	220	1490	95.0	0.90	385					1532
Y2-355M2-4	250	1490	95.2	0.90	436	2.1	0.8	2.2	6.9	1588
Y2-355L1-4	280	1490	95.2	0.90	488					1830
Y2-355L2-4	315	1490	95.3	0.90	547					1957
6极—同步转速 1000(r/min) 50HZ 6 poles—Synchronous speed 1000 rpm 50HZ										
Y2-71M1-6	0.18	850	56.0	0.66	0.74	1.9	1.5	2.0	4.0	8.5
Y2-71M2-6	0.25	850	59.0	0.68	0.95					10
Y2-80M1-6	0.37	885	62.0	0.70	1.28					13
Y2-80M2-6	0.55	885	65.0	0.72	1.74	2.0	1.3	2.1	6.5	15
Y2-90S-6	0.75	910	69.0	0.72	2.3					19
Y2-90L-6	1.1	910	72.0	0.73	3.1					23
Y2-100L-6	1.5	940	76.0	0.75	3.9	2.0	1.2	7.0	7.0	30
Y2-112M-6	2.2	935	79.0	0.76	5.6					40
Y2-132S-6	3	960	81.0	0.76	7.4					55
Y2-132M1-6	4	960	82.0	0.76	9.6	2.1	1.2	2.1	6.5	63
Y2-132M2-6	5.5	960	84.0	0.77	12.9					74
Y2-160M-6	7.5	970	86.0	0.77	17.0					106
Y2-160L-6	11	970	87.5	0.78	24.3	2.0	1.2	2.1	7.0	132
Y2-180L-6	15	970	89.0	0.81	31.6					176
Y2-200L1-6	18.5	970	90.0	0.81	44.7					213
Y2-200L2-6	22	970	90.0	0.83	34.1	2.1	1.2	2.1	7.0	223
Y2-225M-6	30	980	91.5	0.84	59.3	2.0				295
Y2-250M-6	37	980	92.0	0.86	71	2.1				1.1
Y2-280S-6	45	980	92.5	0.86	86		469			
Y2-280M-6	55	980	92.8	0.86	104.5		529			
Y2-315S-6	75	985	93.5	0.86	141.7	2.0	1.0	2.0	6.7	820
Y2-315M-6	90	985	93.8	0.86	169.5					905
Y2-315L1-6	110	985	94.0	0.86	206.7					968

型号 Type	额定功率 Rated Power (kW)	额定转速 Rated Speed (r/min)	效率 EFF $\eta$ (%)	功率因数 Power Factor ( $\cos\phi$ )	额定电流 Rated Current (A)	堵转转矩	最小转矩	最大转矩	堵转电流	重量 Weight (kg)		
						Locked Torque 额定转矩 Rated Torque	Min Torque 额定转矩 Rated Torque	Max Torque 额定转矩 Rated Torque	Locked Current 额定电流 Rated Current			
Y2-315L2-6	132	985	94.2	0.87	244.7	2.0	1.0	2.0	6.7	1078		
Y2-355M1-6	160	990	94.5	0.88	300	1.9				0.9	6.7	1496
Y2-355M2-6	185	990	94.5	0.88	346		1518					
Y2-355M3-6	200	990	94.5	0.88	374		1596					
Y2-355L1-6	220	990	94.5	0.88	409		1654					
Y2-355L2-6	250	990	94.5	0.88	445		1596					
8极—同步转速 750(r/min) 50HZ 8 poles—Synchronous speed 750 rpm 50HZ												
Y2-80M1-8	0.18	645	51.0	0.61	0.87	1.8	1.3	0.9	3.3	18		
Y2-80M2-8	0.25	645	54.0	0.61	1.14					20		
Y2-90S-8	0.37	670	62.0	0.61	1.5			1.2	4.0	6.0	23	
Y2-90L-8	0.55	670	63.0	0.61	2.2						25	
Y2-100L1-8	0.75	720	71.0	0.67	2.4						33	
Y2-100L2-8	1.1	720	73.0	0.69	3.3			2.0	5.0	6.0	38	
Y2-112M-8	1.5	690	75.0	0.69	4.5						50	
Y2-132S-8	2.2	705	78.0	0.71	6.0			1.9	1.1	2.0	6.6	63
Y2-132M-8	3	705	79.0	0.73	7.9							79
Y2-160M1-8	4	720	81.0	0.73	10.3			2.0	1.1	2.0	6.6	103
Y2-160M2-8	5.5	720	73.0	0.74	13.6	106						
Y2-160L-8	7.5	720	85.5	0.75	17.9	1.9	1.0	2.0	6.6	120		
Y2-180L-8	11	730	87.5	0.76	25.3					172		
Y2-200L-8	15	730	88.0	0.76	34.1	1.8	0.9	2.0	6.4	222		
Y2-225S-8	18.5	730	90.0	0.76	41.3					283		
Y2-225M-8	22	740	90.5	0.78	47.6	1.8	0.9	2.0	6.4	307		
Y2-250M-8	30	735	91.0	0.79	64					402		
Y2-280S-8	37	740	91.5	0.79	76.83	1.8	0.9	2.0	6.4	476		
Y2-280M-8	45	740	92.0	0.79	93					531		
Y2-315S-8	55	735	92.8	0.81	111.2	1.8	0.9	2.0	6.4	752		
Y2-315M-8	75	735	93.0	0.81	151.3					910		
Y2-315L1-8	90	735	93.8	0.82	177.8	1.8	0.9	2.0	6.4	998		
Y2-315L2-8	110	735	94.0	0.82	216.8					1042		
Y2-355M1-8	132	740	93.7	0.82	260	1.8	0.9	2.0	6.4	1500		
Y2-355M2-8	160	740	94.2	0.82	310					1596		
Y2-355L1-8	185	740	94.3	0.82	357	1.8	0.9	2.0	6.4	1722		
Y2-355L2-8	200	740	94.5	0.83	386					1740		
Y2-355L3-8	220	740	94.5	0.83	425	1765						
10极—同步转速 600(r/min) 50HZ 10 poles—Synchronous speed 600 rpm 50HZ												
Y2-315S-10	45	590	91.5	0.75	99.6	1.5	0.8	2.0	6.2	830		
Y2-315M-10	55	590	92.0	0.75	121.1					850		
Y2-315L1-10	75	590	92.5	0.76	162.1					994		
Y2-315L2-10	90	590	93.0	0.77	191					1100		
Y2-355M1-10	110	590	93.2	0.78	230	1.3	0.8	2.0	6.0	1556		
Y2-355M2-10	132	590	93.5	0.78	275					1580		
Y2-355L-10	160	590	93.5	0.78	333.3					1775		

### B3 安装形式

Mounting arrangements B3

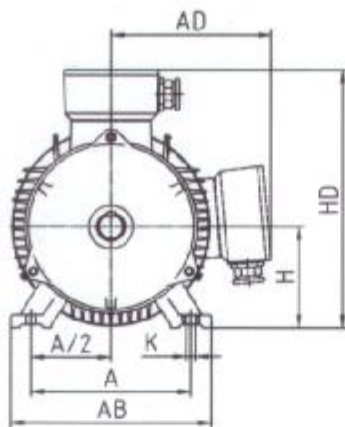
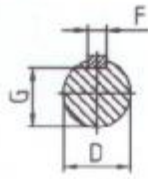

机座号(Frame No.) 63-71

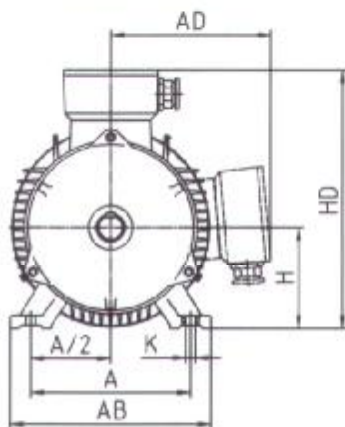

机座号(Frame No.) 80-355

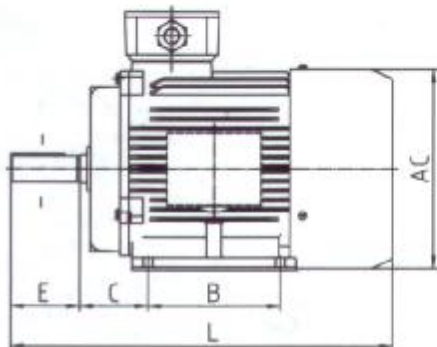

机座号(Frame No.) 63-90

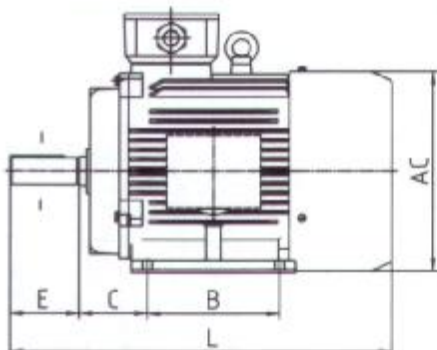

机座号(Frame No.) 100-132

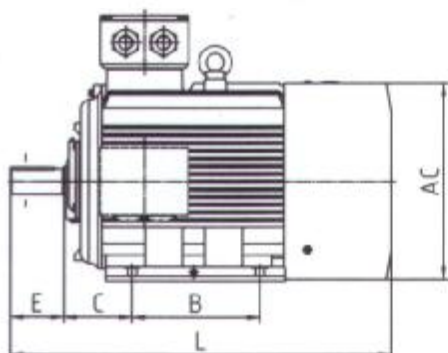

机座号(Frame No.) 160-355

### B5 安装形式

Mounting arrangements B5

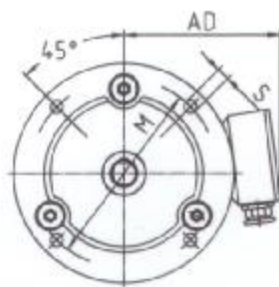
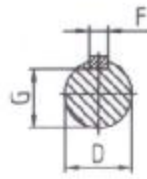

机座号(Frame No.) 63-90

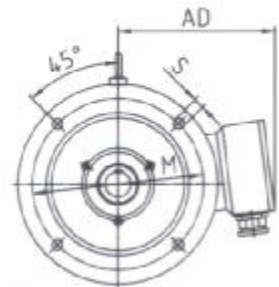

机座号(Frame No.) 100-200

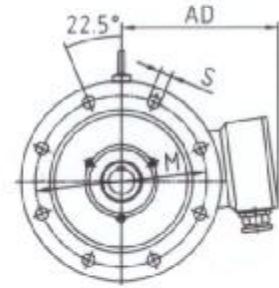

机座号(Frame No.) 225-280

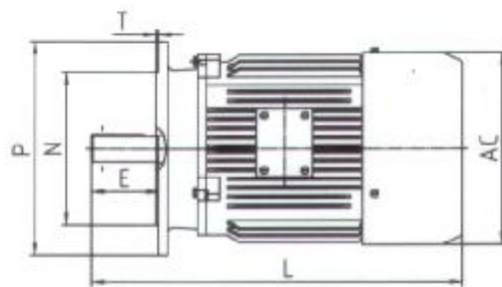

机座号(Frame No.) 63-90

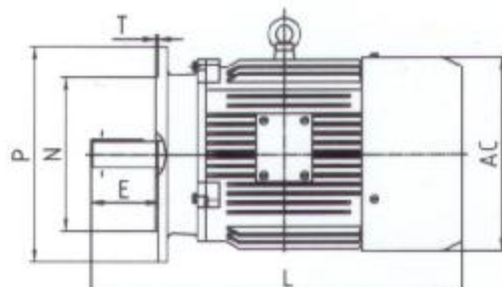

机座号(Frame No.) 100-132

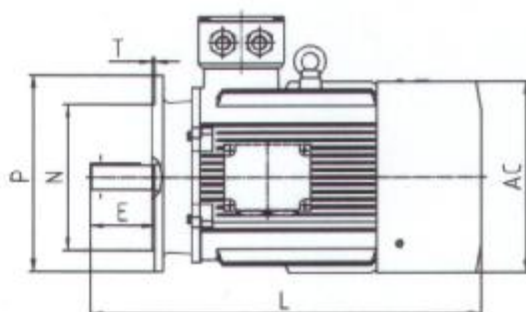

机座号(Frame No.) 160-280

### B35 安装形式

Mounting arrangements B35

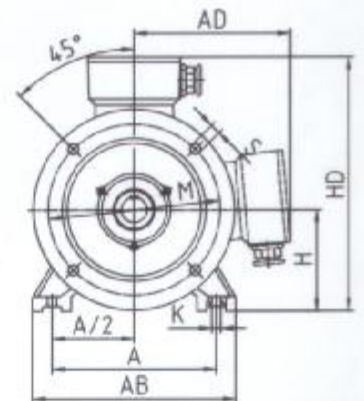
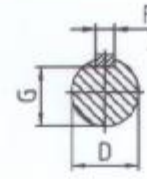

机座号(Frame No.) 63-200

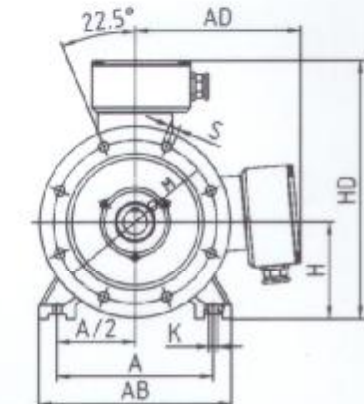

机座号(Frame No.) 225-355

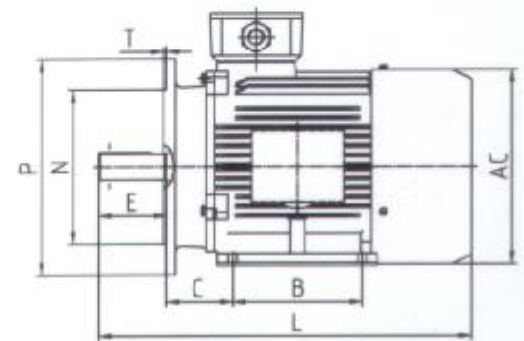

机座号(Frame No.) 63-90

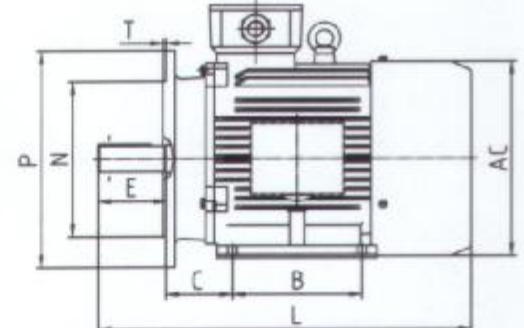

机座号(Frame No.) 100-132

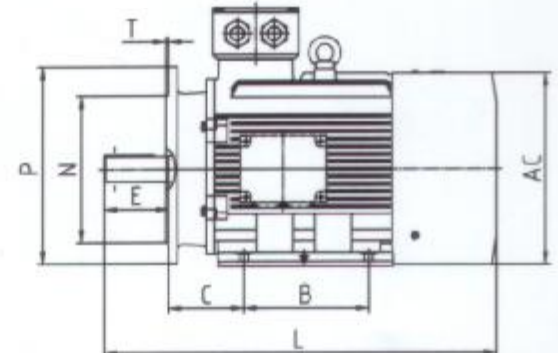

机座号(Frame No.) 160-355

外型及安装尺寸

Outline and Mounting Dimensions

机座号 Frame No.	极数 Poles No.	安装尺寸 Mounting Dimensions																	外形尺寸 Outline Dimensions												
		A	A/2	B	C	D	E	F	G	H	K	M	N	P	R	S	T	凸缘孔数 Holes No.	AB	AC	AD	HD	L								
63M	2.4	100	50	80	40	11	+0.008	23	±0.26	4	0	8.5	0	63	7	115	95	+0.013	140	±1.5	10	+0.36	3	0	-0.10	135	130	117	180	230	
71M	2.4.6	112	56	90	45	14	-0.003	30	±0.26	5	0	11	0	71	7	130	110	-0.009	160	±1.5	10	0	3	0	-0.10	150	145	122	195	255	
80M	2.4.6.8	125	62.5	100	50	±1.5	19	40	±0.31	6	0	15.5	-0.10	80	10	165	130	±0.014	200	±1.5	12	±1.0	3.5	0	-0.10	165	175	145	220	295	
90S		140	70	125	56	±2.0	24	+0.009	50	±0.31	8	0	20	0	90	10	165	130	+0.014	200	±1.5	12	+0.43	3.5	0	-0.10	180	195	155	250	320
90L		140	70	125	56	±2.0	24	+0.009	50	±0.31	8	0	20	0	90	10	165	130	+0.014	200	±1.5	12	+0.43	3.5	0	-0.10	180	195	155	250	345
100L		160	80	140	63	±2.0	28	-0.004	60	±0.37	8	0	24	0	100	12	215	180	-0.011	250	±2.0	14.5	±1.0	4	0	-0.10	205	215	180	270	385
112M		190	95	140	70	±2.0	28	-0.036	60	±0.37	8	0	24	0	112	12	215	180	-0.011	250	±2.0	14.5	±1.0	4	0	-0.10	230	240	190	300	400
132S		216	108	178	89	±2.0	38	80	10	33	132	0	132	-0.5	132	12	265	230	300	0	±2.0	14.5	±1.0	4	0	-0.10	270	275	210	345	470
132M		216	108	178	89	±2.0	38	80	10	33	132	0	132	-0.5	132	12	265	230	300	0	±2.0	14.5	±1.0	4	0	-0.10	270	275	210	345	510
160M		254	127	210	108	±3.0	42	+0.018	12	37	-0.20	160	14.5	300	250	+0.016	350	±3.0	18.5	0	±3.0	18.5	±1.2	5	0	-0.12	320	330	255	420	615
160L		254	127	254	108	±3.0	42	+0.002	12	37	-0.20	160	14.5	300	250	-0.013	350	±3.0	18.5	0	±3.0	18.5	±1.2	5	0	-0.12	320	330	255	420	670
180M		279	139.5	241	121	±3.0	48	110	±0.43	14	0	42.5	180	18.5	350	300	±0.016	400	±4.0	18.5	0	±4.0	18.5	5	0	-0.12	355	380	280	455	700
180L	279	139.5	279	121	±3.0	48	110	±0.43	14	0	42.5	180	18.5	350	300	±0.016	400	±4.0	18.5	0	±4.0	18.5	5	0	-0.12	355	380	280	455	740	
200L	318	159	305	133	±4.0	55	140	±0.50	16	0	49	200	18.5	400	350	±0.016	450	±4.0	18.5	0	±4.0	18.5	5	0	-0.12	395	420	305	505	770	
225S	4.8	356	178	311	±4.0	60	+0.030	140	±0.50	18	53	225	18.5	400	350	±0.018	450	±4.0	18.5	0	±4.0	18.5	5	0	-0.12	435	470	335	560	815	
225M	2	356	178	311	±4.0	55	+0.011	110	±0.43	16	49	225	18.5	400	350	±0.018	450	±4.0	18.5	0	±4.0	18.5	5	0	-0.12	435	470	335	560	820	
	4.6.8	356	178	311	±4.0	60	+0.011	140	±0.50	18	53	225	18.5	400	350	±0.018	450	±4.0	18.5	0	±4.0	18.5	5	0	-0.12	435	470	335	560	845	
250M	2	406	203	349	168	±4.0	60	180	0	53	250	18.5	400	350	±0.018	450	±4.0	18.5	0	±4.0	18.5	5	0	-0.12	490	510	370	615	910		
	4.6.8	406	203	349	168	±4.0	65	180	-0.043	58	250	18.5	400	350	±0.018	450	±4.0	18.5	0	±4.0	18.5	5	0	-0.12	490	510	370	615	910		
280S	2	457	228.5	368	190	±4.0	75	140	0	67.5	280	18.5	450	450	±0.020	550	±4.0	18.5	0	±4.0	18.5	5	0	-0.12	550	580	410	680	985		
	4.6.8	457	228.5	368	190	±4.0	75	140	-0.052	67.5	280	18.5	450	450	±0.020	550	±4.0	18.5	0	±4.0	18.5	5	0	-0.12	550	580	410	680	985		
280M	2	457	228.5	419	190	±4.0	65	140	0	58	280	18.5	450	450	±0.020	550	±4.0	18.5	0	±4.0	18.5	5	0	-0.12	550	580	410	680	1035		
	4.6.8	457	228.5	419	190	±4.0	75	140	-0.043	58	280	18.5	450	450	±0.020	550	±4.0	18.5	0	±4.0	18.5	5	0	-0.12	550	580	410	680	1035		
315S	2	508	254	457	216	±4.0	65	140	0	58	315	18.5	450	450	±0.022	660	0	±4.0	18.5	0	±4.0	18.5	6	0	-0.15	635	645	530	845	1240	
	4.6.8.10	508	254	457	216	±4.0	80	170	-0.043	71	315	18.5	450	450	±0.022	660	0	±4.0	18.5	0	±4.0	18.5	6	0	-0.15	635	645	530	845	1270	
315M	2	508	254	457	216	±4.0	65	140	0	58	315	18.5	450	450	±0.022	660	0	±4.0	18.5	0	±4.0	18.5	6	0	-0.15	635	645	530	845	1350	
	4.6.8.10	508	254	457	216	±4.0	80	170	-0.043	71	315	18.5	450	450	±0.022	660	0	±4.0	18.5	0	±4.0	18.5	6	0	-0.15	635	645	530	845	1380	
315L	2	508	254	508	216	±4.0	65	140	0	58	315	18.5	450	450	±0.022	660	0	±4.0	18.5	0	±4.0	18.5	6	0	-0.15	635	645	530	845	1350	
	4.6.8.10	508	254	508	216	±4.0	80	170	-0.043	71	315	18.5	450	450	±0.022	660	0	±4.0	18.5	0	±4.0	18.5	6	0	-0.15	635	645	530	845	1380	
355M	2	610	305	560	254	±4.0	75	140	0	67.5	355	18.5	450	450	±0.025	800	0	±4.0	18.5	0	±4.0	18.5	6	0	-0.15	730	710	655	1010	1500	
	4.6.8.10	610	305	560	254	±4.0	95	170	+0.035	86	355	18.5	450	450	±0.025	800	0	±4.0	18.5	0	±4.0	18.5	6	0	-0.15	730	710	655	1010	1530	
355L	2	610	305	630	254	±4.0	75	140	+0.030	67.5	355	18.5	450	450	±0.025	800	0	±4.0	18.5	0	±4.0	18.5	6	0	-0.15	730	710	655	1010	1500	
	4.6.8.10	610	305	630	254	±4.0	95	170	+0.011	86	355	18.5	450	450	±0.025	800	0	±4.0	18.5	0	±4.0	18.5	6	0	-0.15	730	710	655	1010	1530	

注: R尺寸为凸缘配合面至轴伸肩的距离。 Note: Size R is the distance between the flange fitting surface and the shaft shoulder.